

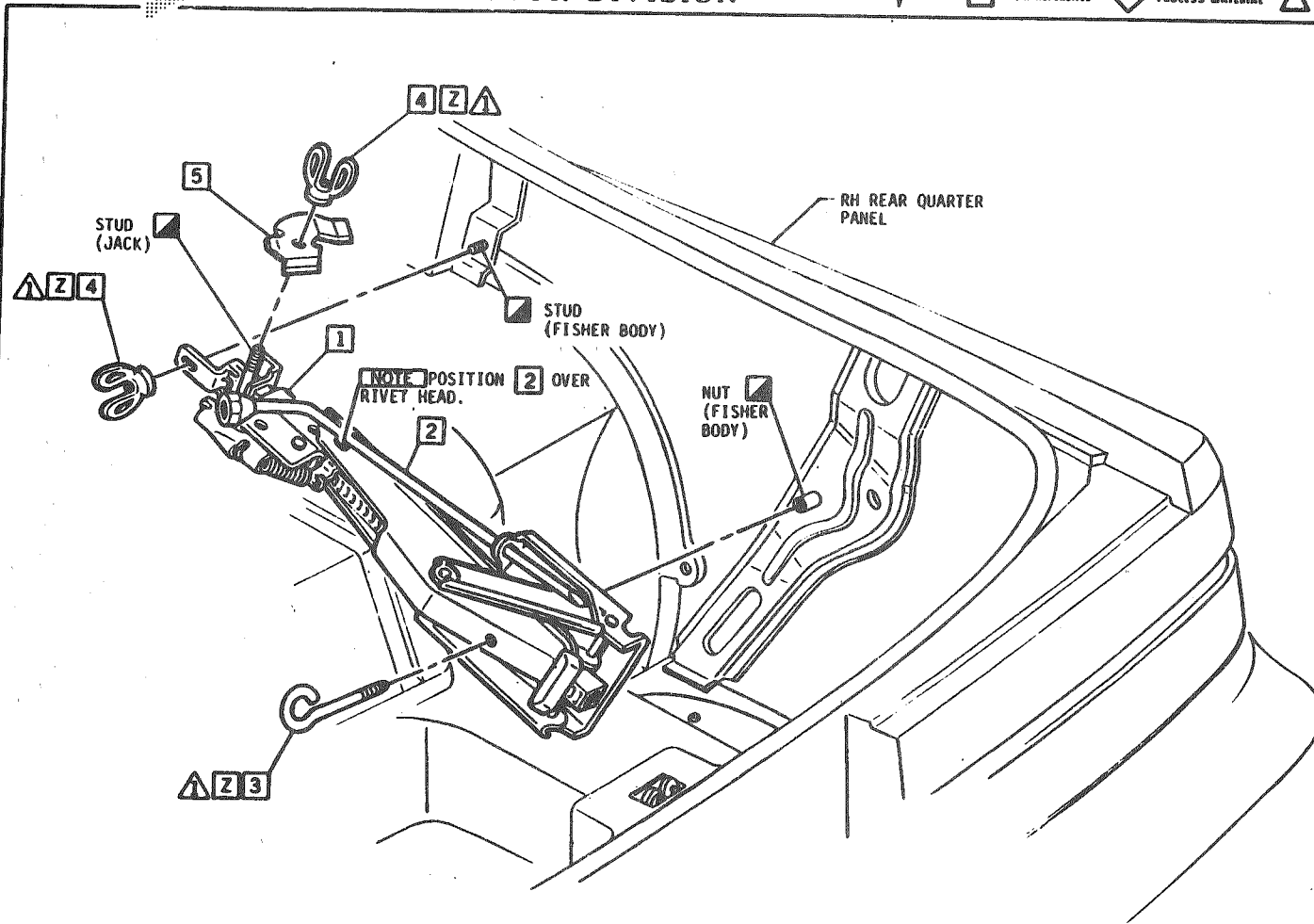

General Motors Corporation
CHEVROLET MOTOR DIVISION

PRODUCT DESCRIPTION MANUAL

ITEM REFERENCE
 PROCESS MATERIAL
 TORQUE
 EXISTING AS PART OF



- 14089447 JACK ASM
- 14050119 WRENCH WHEEL
- 14085678 BOLT/SCREW-STORAGE
- 14074740 NUT
- 14036367 RETAINER

TIGHTEN SECURELY

DYNAMIC (Instel) N-m	HAND (Insp.) N-m	DATE	SYN	REVISION	AVTM	DR	CR	ESD C/S	DATE	DIV	TITLE	
<input type="checkbox"/>	3.5-4.5								11/05	CHEVROLET	1986 F PASSENGER 14089402	
<input type="checkbox"/>									DR R. KATULSKI		AUTO. JACK STORAGE	
<input type="checkbox"/>									CR <i>R. Katulski</i>		FAOD ALL	
<input type="checkbox"/>									APPR S			
<input type="checkbox"/>									APPR			
<input type="checkbox"/>									APPR	REV ECA 41600	IL-22533 S	
<input type="checkbox"/>									APPR	C/O 04JAB5	IL-23891 S	
										UPY	14E	SHEET
											C1	

FULLY DRIVEN, SEATED & NOT STRAPPED

C D O P Co